

CLUTCH BUTTONS

WFP PART
NUMBER

FMC
NUMBER

THICKNESS
(INCHES)

THICKNESS
(MM)

CERAMIC BRONZE

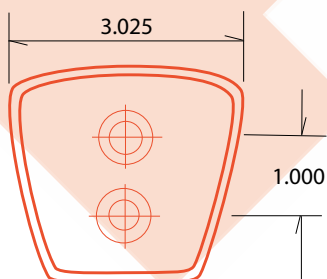
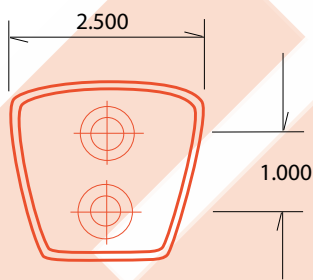
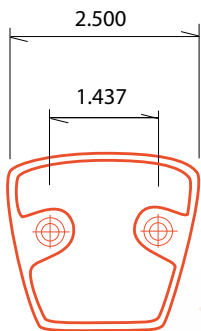
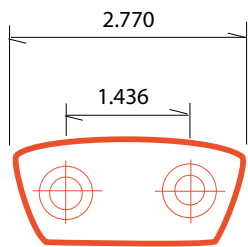
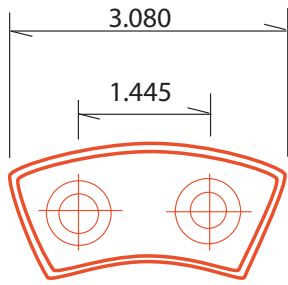

1H-125	1H-125	0.125	3.20
1H-140	1H-140	0.140	3.60
1H-156	1H-156	0.156	4.00
1H-173	1H-173	0.173	4.40
1H-187	1H-187	0.187	4.80
1H-218	1H-218	0.218	5.50
VTS-2	SS1.32	0.125	3.20
VTS-4	SS1.36	0.140	3.60
VTS-4/5	SS1.38	0.150	3.80
VTS-5	SS1.40	0.156	4.00
VTSG-3	SS8.38	0.150	3.80
EVT-2	SS4.32	0.125	3.20
EVT-4	SS4.36	0.140	3.60
EVT-5	SS4.40	0.156	4.00
EVT-6	SS4.43	0.169	4.30
EVT-7	SS4.40	0.175	4.40
EVT-8	SS4.48	0.187	4.80
EVT-9	SS4.50	0.218	5.50
VT-2	SS2.32	0.125	3.20
VT-4	SS2.36	0.140	3.60
VT-4/5	SS2.38	0.150	3.80
VT-5	SS2.40	0.145	4.00
VT-6	SS2.43	0.169	4.30
VT-7	SS2.44	0.175	4.40
VT-8	SS2.48	0.187	4.80
VT-9	SS2.55	0.218	5.50
VTL-2	SS3.32	0.125	3.20
VTL-4	SS3.36	0.140	3.60
VTL-4/5	SS3.38	0.150	3.80
VTL-5	SS3.40	0.156	4.00
VTL-6	SS3.43	0.169	4.30
VTL-7	SS3.44	0.175	4.40
VTL-8	SS3.48	0.187	4.80
VTL-9	SS3.55	0.218	5.50

CLUTCH BUTTONS

WFP PART NUMBER	FMC NUMBER	THICKNESS (INCHES)	THICKNESS (MM)
CERAMIC BRONZE			
VSR-10	SS5.34	0.133	3.40
VSR-11	SS5.40	0.156	4.00
VSR-12	SS5.44	0.178	4.40
VSR-13	SS5.48	0.187	4.80
VSR-19	SS6.32	0.124	3.20
VSR-20	SS6.34	0.133	3.40
VSR-21	SS6.40	0.156	4.00
VSR-22	SS6.44	0.178	4.40
VSR-23	SS6.48	0.187	4.80
BVT-11004	TBA	0.140	3.60
VTD-2	SS9.32	0.126	3.20
VTD-4	SS9.36	0.142	3.60
VTD-4/5	SS9.38	0.150	3.80
VTD-5	SS9.40	0.157	4.00
VTD-6	SS9.43	0.169	4.30
VTD-7	SS9.44	0.177	4.40
VTD-8	SS9.48	0.189	4.80
VTD-5 (R)	SS9.40R	0.157	4.00
VTDG-4	SS10.36	0.142	3.60
VTDG-5	SS10.40	0.157	4.00
VTDG-4 (R)	SS10.36R	0.142	3.60
VTDG-5 (R)	SS10.40R	0.157	4.00

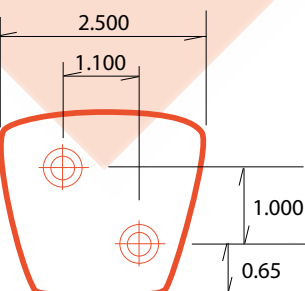
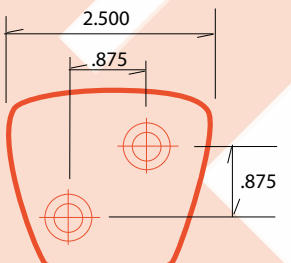
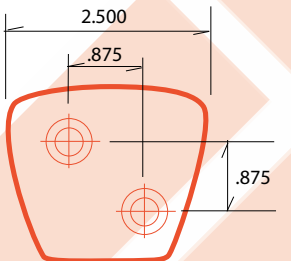
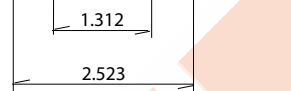
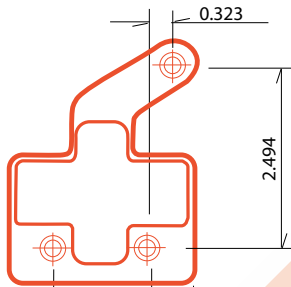
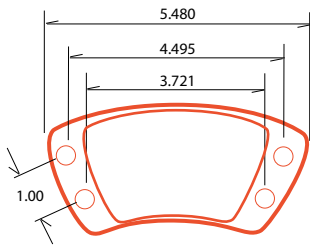
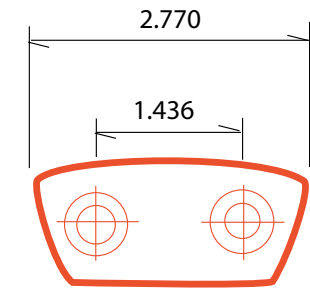

CLUTCH BUTTONS

WFP PART NUMBER	FMC NUMBER	THICKNESS (INCHES)	THICKNESS (MM)
CERAMIC BRONZE			
VTLD-2	SS11.32	0.126	3.20
VTLD-4	SS11.36	0.142	3.60
VTLD-4/5	SS11.38	0.150	3.80
VTLD-5	SS11.40	0.156	4.00
VTLD-6	SS11.43	0.169	4.30
VTLD-7	SS11.44	0.175	4.40
VTLD-8	SS11.48	0.187	4.80
VTLD-5 (R)	SS11.40R	0.156	4.00
VTLD-7 (R)	SS11.44R	0.175	4.40
VTLD-8 (R)	SS11.48R	0.187	4.80
VTJ-5	SS12.40	0.156	4.00
VTJ-7	SS12.44	0.175	4.40
VTJ-8	SS12.48	0.187 </td <td>4.80</td>	4.80
VTJ-8.5	SS12.50	0.197	5.00
VTLJ-5	SS14.40	0.156	4.00
VTLJ-7	SS14.44	0.175	4.40
VTLJ-8	SS14.48	0.187	4.80
VTLJ-8.5	SS14.50	0.197	5.00

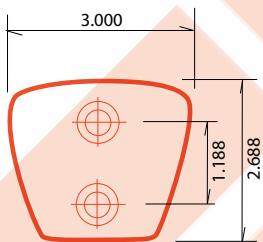
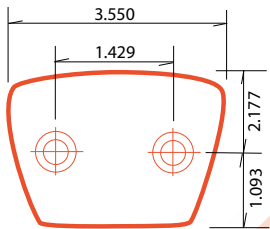
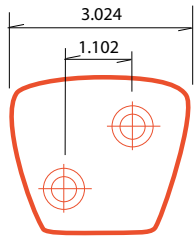
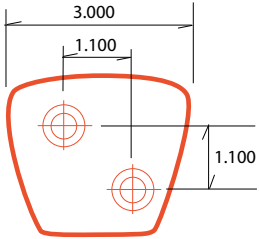

RIVETS

DIAMETER	FMC NUMBER	LENGTH (INCHES)	LENGTH (MM)
3/8" 9.5MM	SR176	0.301	7.60
	SR184	0.331	8.40
	SR192	0.361	9.20
	SR1100	0.395	10.00
1/2" 12.5MM	SR377	0.305	7.70
	SR385	0.335	8.50
	SR393	0.365	9.30

Facing Groove Details

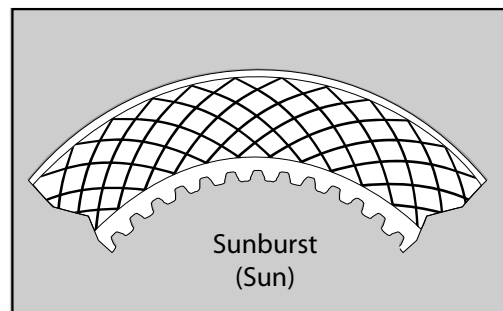
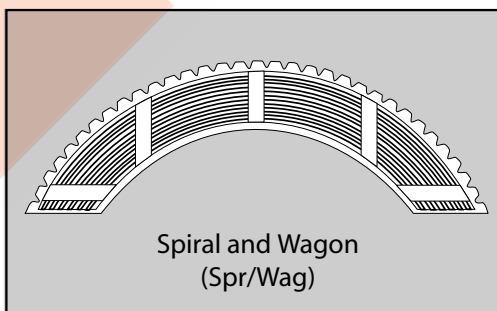
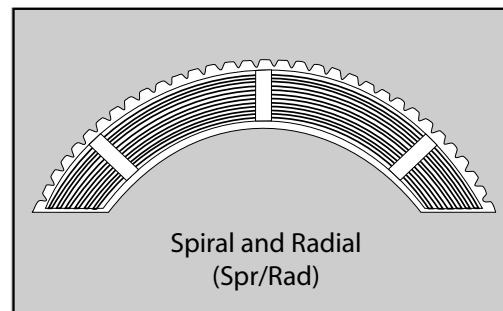
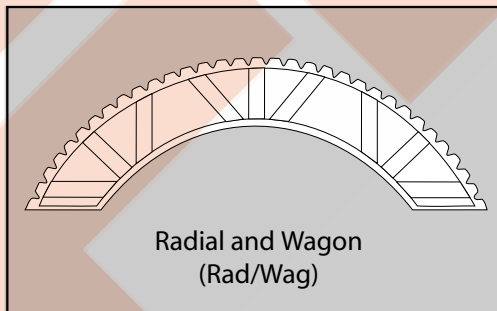
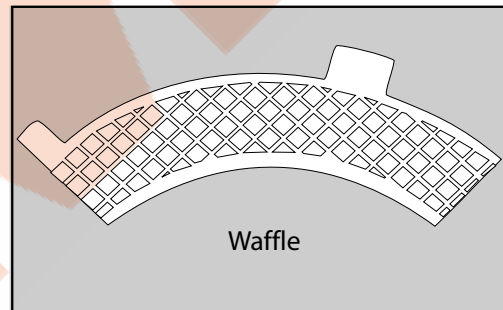
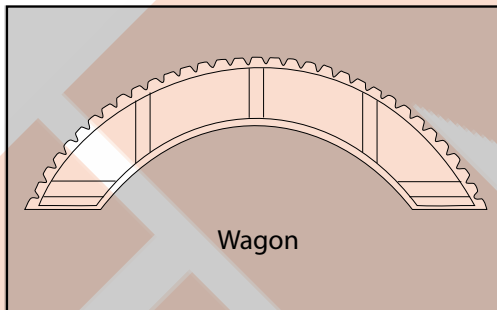
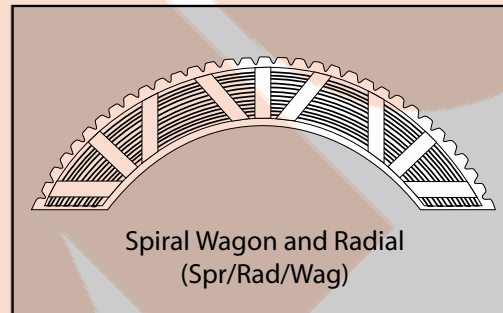
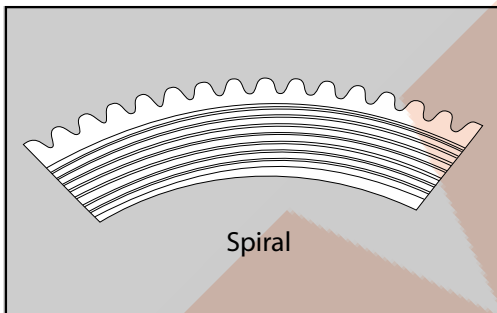
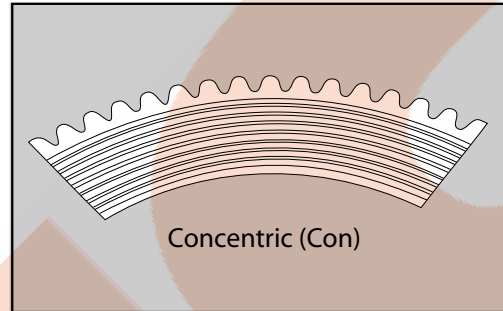
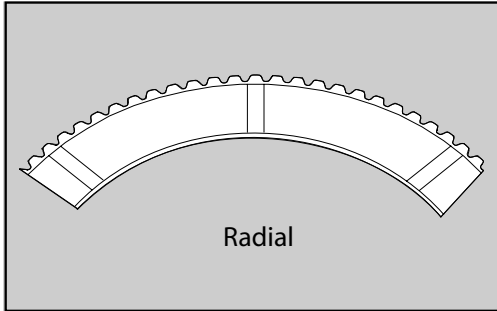
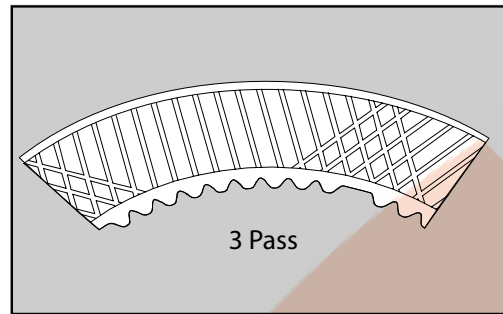
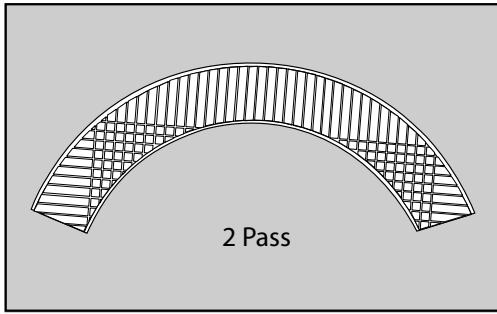

Core Plate Drive Features

